

# INSTALLATION OF ENE CICLO "Wing Shifter"

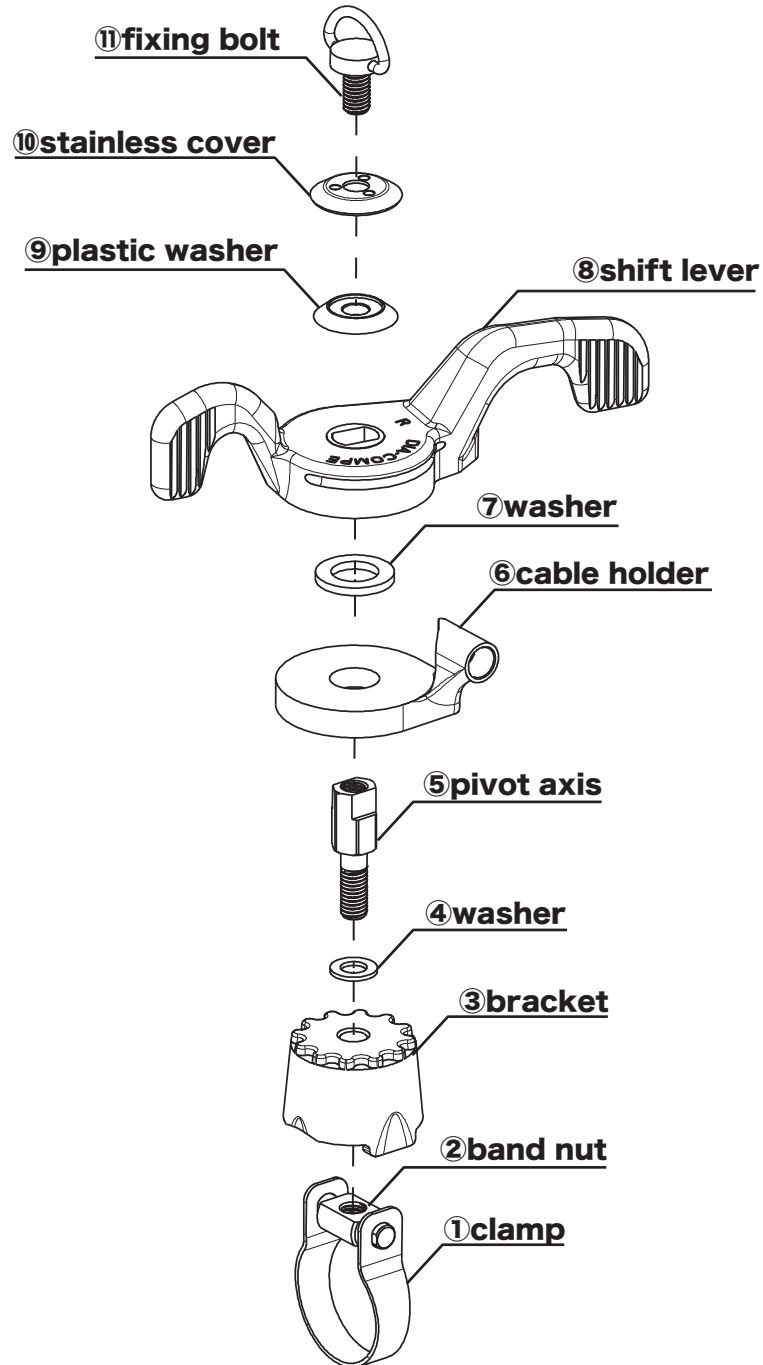

## \*CAUTION\*

1. Wing Shifter has a power ratchet mechanism and is compatible with any 11 speed derailleurs except SRAM components.

2. Before installing the shifter onto the handle bar, it has no ratchet sound. You can find it after complete installation.

1. Install the clamp parts ① & ② to the handle bar to set a position of the bracket ③.

Note: The clamp band must be placed in the groove inside of the bracket.  
※ Handle bar size:  $\Phi 22.2\text{mm}$  -  $\Phi 24\text{mm}$

2. After setting the bracket position, tighten the pivot axis ⑤ to fix it to the handle bar by 8mm open wrench.

Note: The washer ④ must be assembled between the pivot axis and the bracket.

3. Be sure the pivot axis must be tightened firmly. Tightening torque: 4 - 6 Nm {40 - 60kgf.cm}

4. Assemble the cable holder ⑥ onto the bracket and adjust the shift lever position with cable route. Cable route must be smooth to the handle bar without any interference.



# INSTALLATION OF ENE CICLO "Wing Shifter"

5. Assemble the washer ⑦ and the shift lever to the bracket .



6. Put the plastic washer ⑨ and the stainless cover ⑩ on the shift lever.



7. Set the fixing bolt ⑪ to the pivot axis to fix the shift lever

**\*CAUTION\***

3. Back side of the plastic washer ⑨ has four studs. When the plastic washer ⑨ is assembled to the shift lever, those 4 studs must be fixed into an oval shape hole of the shift lever securely. If they do not fit together, the 4 studs can be broken and the shifter won't work well.



**Check out new video on YouTube!**



[https://www.youtube.com/watch?v=X951eK-gl\\_w](https://www.youtube.com/watch?v=X951eK-gl_w)

DIA-COMPE, TAIWAN CO., LTD  
NO.62,35TH RD., TAICHUNG INDUSTRIAL PARK, TAICHUNG, TAIWAN, R.O.C.  
TEL:886-4-2359-1117 FAX:886-4-2359-3188 [www.diacompe.com.tw](http://www.diacompe.com.tw)

July, 2018